

Making a simple clock model using TS/2D Design

Go through this tutorial - You will need to create your own shapes and have your 2D design files for your 'contoured stained glass windows' available (you can get this off your google drive).

Step 1

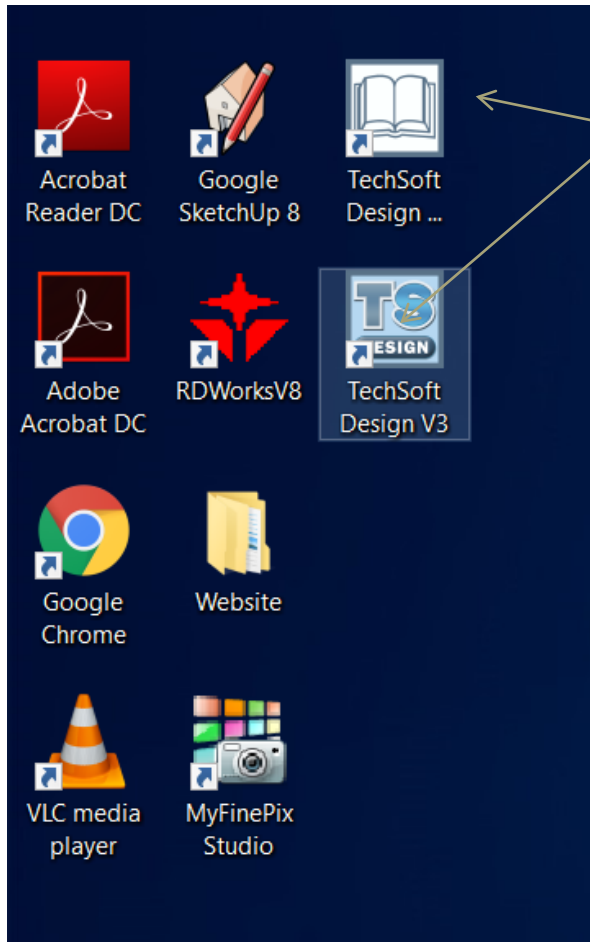

If you have successfully managed to download TS Design it should appear on your desktop of your computer/laptop. You will need to double click to open. You will notice there is a TechSoft Design Tutorial as well, you may want to click on this first to go through.

TS Design is basically 2D, it is just the updated version. The new program allows you to undo mistakes unlimited times (if you remember this was a problem with 2D you could only undo once).

Try this by drawing a few shapes then delete them all and the either Edit - Undo or Keyboard shortcut - Ctrl - Z.

Step 2 - Set up your Artboard.

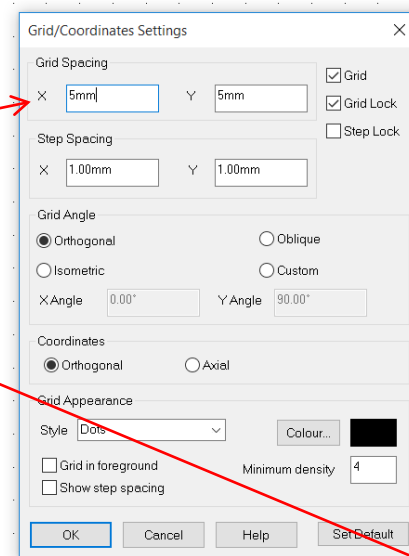
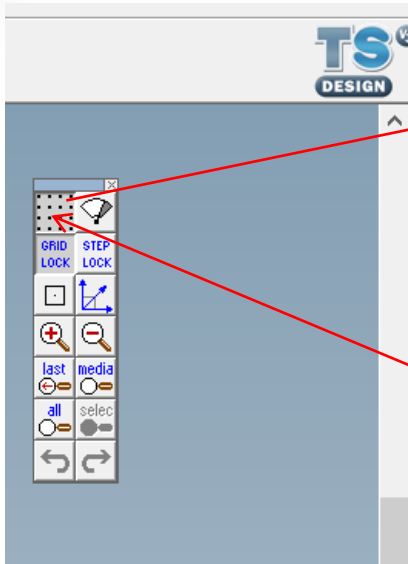

If you do not have your folders, don't worry you can still do this! You will make up your own shapes then draw these onto an A6 piece of paper (if you do not have any paper we can do this as catch up work during intervention sessions when we return to school).

Follow these steps:

1. Switch 'Grid Lock on' (top right tool box)
2. Double click on 'grid' (icon with dots), change grid spacing 'x' and 'y' to 5mm.
3. Go to Top Tab Bar (top of program) and click on 'Setup' - 'Drawing' - 'Layout'. Change 'Standard Size' to ISO A4. Click OK.
4. Now go to File - Save - Save your model as 'Art Deco Model.V1'. Remember to save down regularly

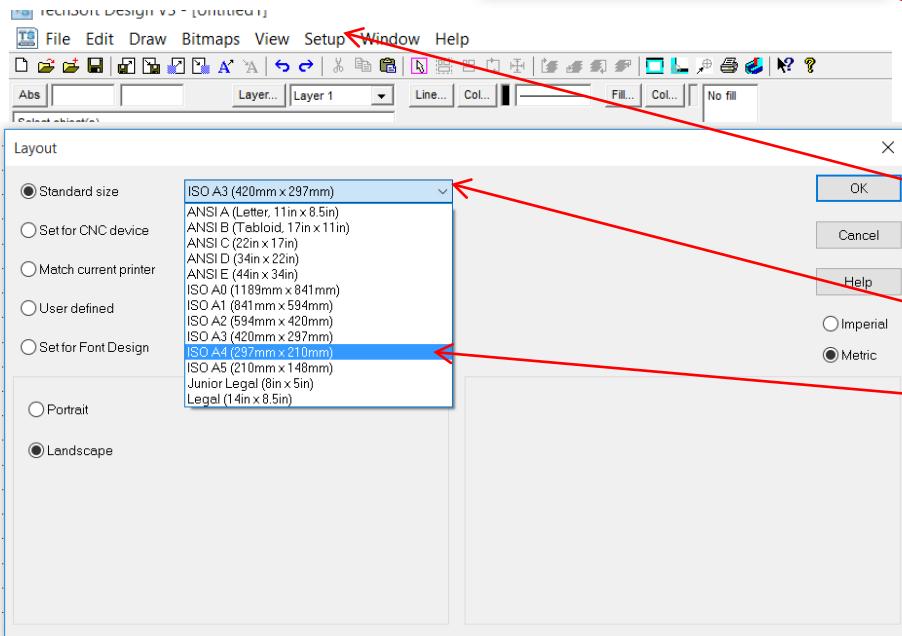

Step 3 - Draw out your shapes

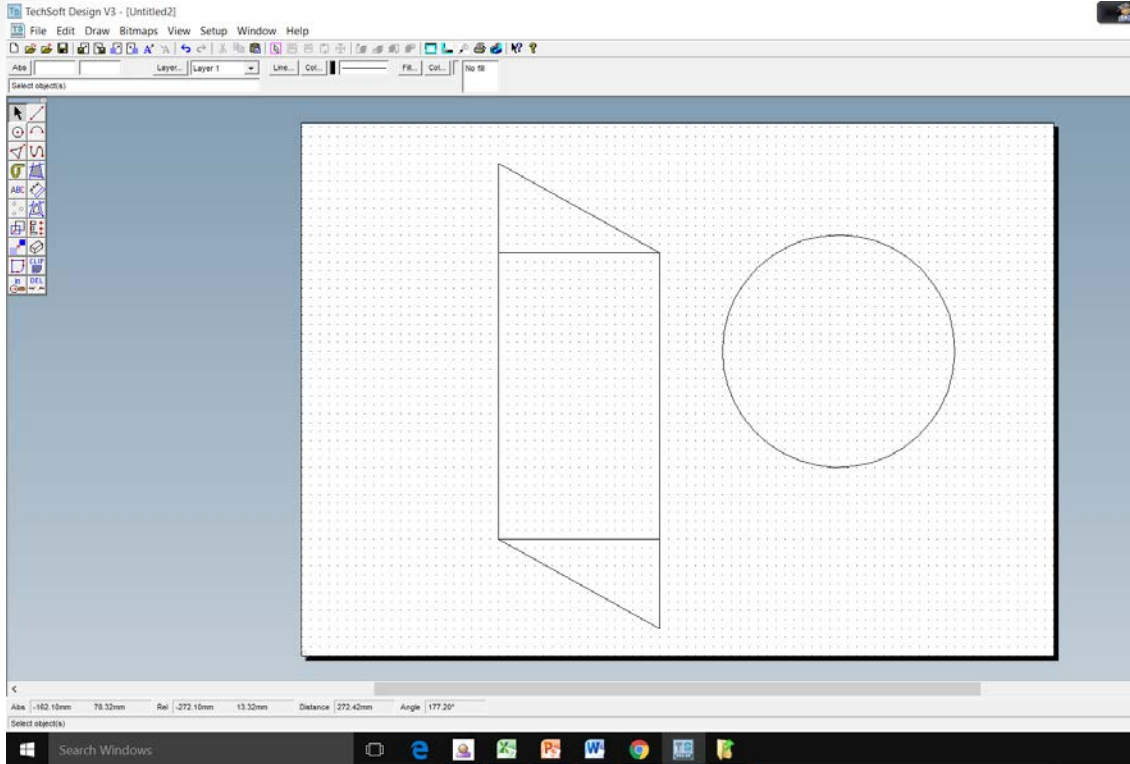

REMEMBER - Do not copy mine exactly, you need to create your own shapes! You may wish to keep the circle though for your clock face, but this could even be changed to a different shape if you wish.

You can use your Frank Lloyd Wright contour clock to make a simple wall clock or you could even make your own modernised stained glass clock. To do this successfully the aim is to keep your shapes to simple geometric forms and only between three to five total shapes.

Follow these steps:

1. Draw out geometric shapes. I used the most simple ones.
2. I chose a rectangle, then drew a triangle (hold right button on mouse down over rectangle shape and choose triangle). I just drew one triangle then copied/pasted another and used diamond to mirror opposite ways.
3. I then drew a circle off the shape.

Step 4 - Add contoured line to shapes

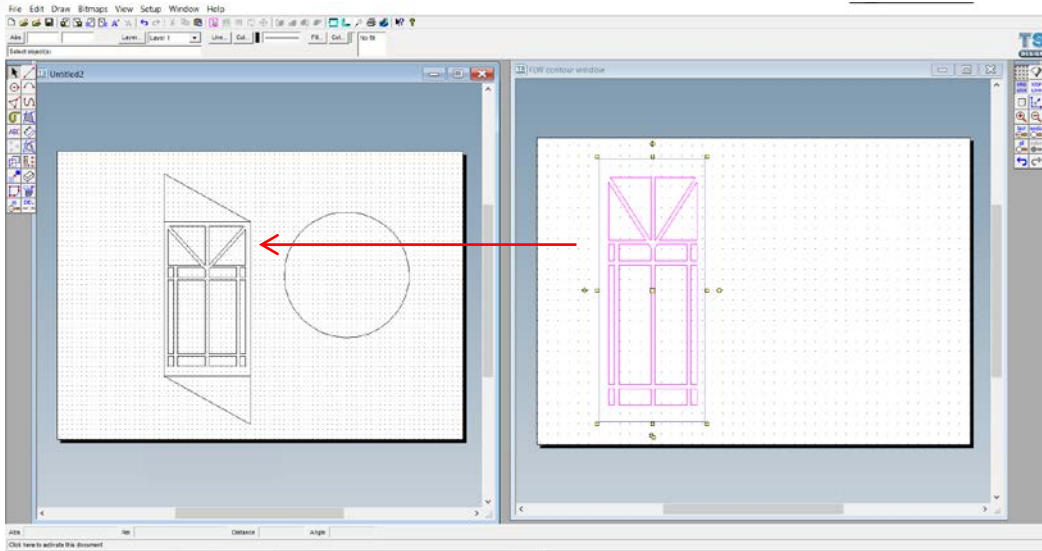

Open your FLW contoured window copy and paste onto your clock rectangle and resize accurately to fit.

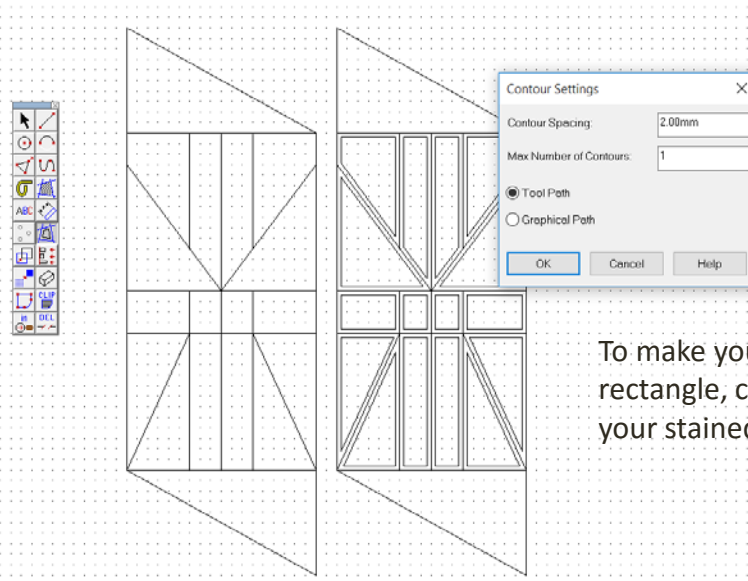

To make your own contoured choose line tool, draw out your lines on the rectangle, choose contour, contour 2mm, click inside the lines to make your stained glass window.

You can use your Frank Lloyd Wright contour clock to make a simple wall clock or you could even make your own modernised stained glass clock. To do this successfully the aim is to keep your shapes to simple geometric forms and only between three to five total shapes.

Follow these steps:

1. Either Open you Frank Lloyd Wright Contoured window file or draw lines onto the rectangle/circle then contour inside the lines to create a different window shape. See two different steps on images.

Step 5 - Add contoured line to shapes

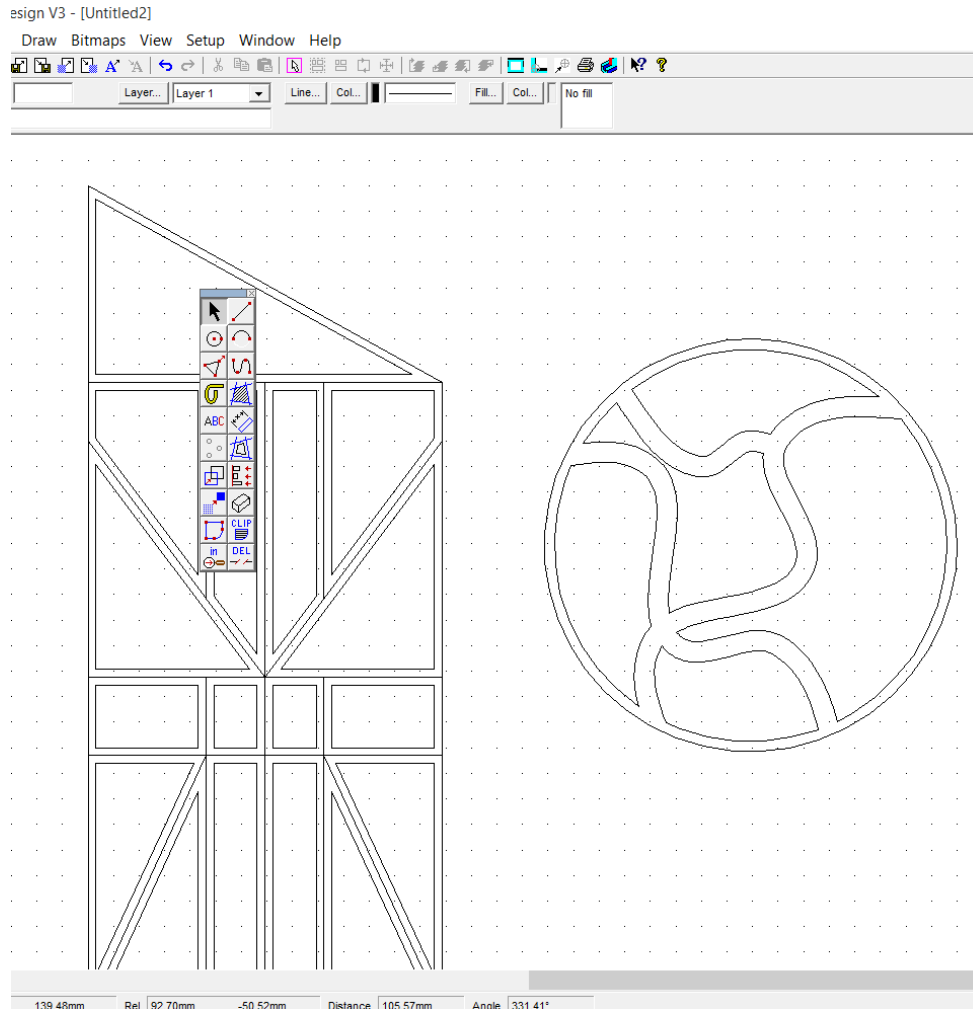

You can use your Frank Lloyd Wright contour clock to make a simple wall clock or you could even make your own modernised stained glass clock. To do this successfully the aim is to keep your shapes to simple geometric forms and only between three to five total shapes.

Follow these steps:

1. Follow the same step on the circle. This time I choose the 'path/curve' tool and drew curves. I then contoured 2mm inside the lines and then delete the lines.
2. Remember when you are drawing the lines they must crossover each other and you then delete the crossover parts to make sure your lines are attached, otherwise you won't be able to contour!

Step 6 - Make a back plate - version 1

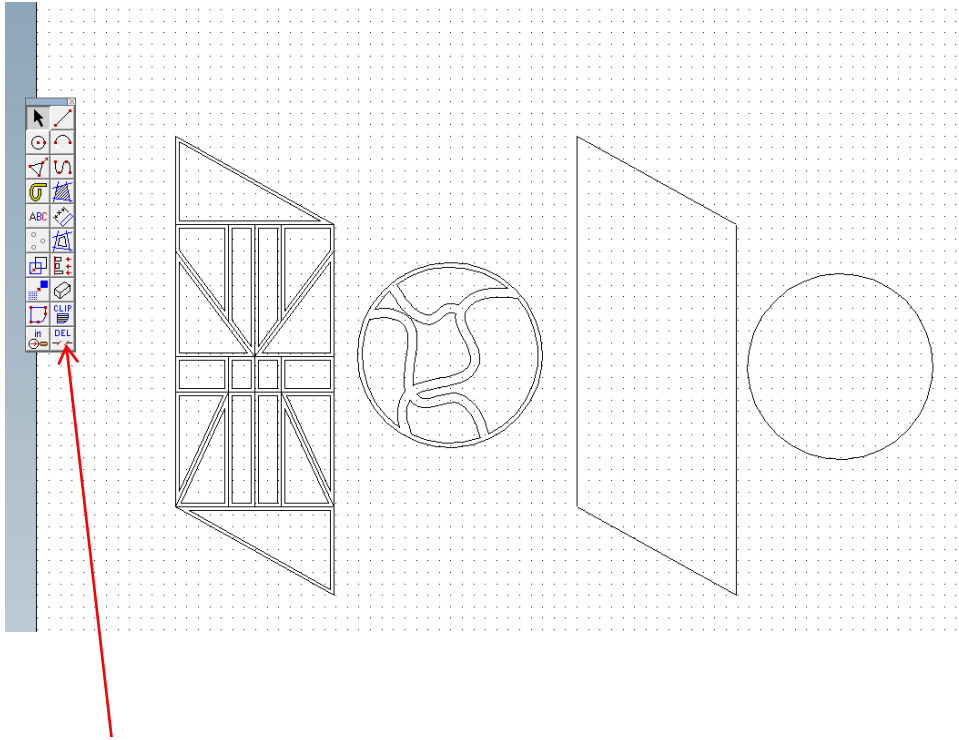

You can delete whole shapes by clicking on the select tool and using the 'Delete' button on your keyboard. If you need to delete sections of a shape you use the delete crossover icon show.

You can use your Frank Lloyd Wight contour clock to make a simple wall clock or you could even make your own modernised stained glass clock. To do this successfully the aim is to keep your shapes to simple geometric forms and only between three to five total shapes.

Follow these steps:

1. **Copy and paste your shapes.**
2. **You need to delete all of the inside lines on two of the shapes.**

Step 7 - Colour lines to cut/engrave

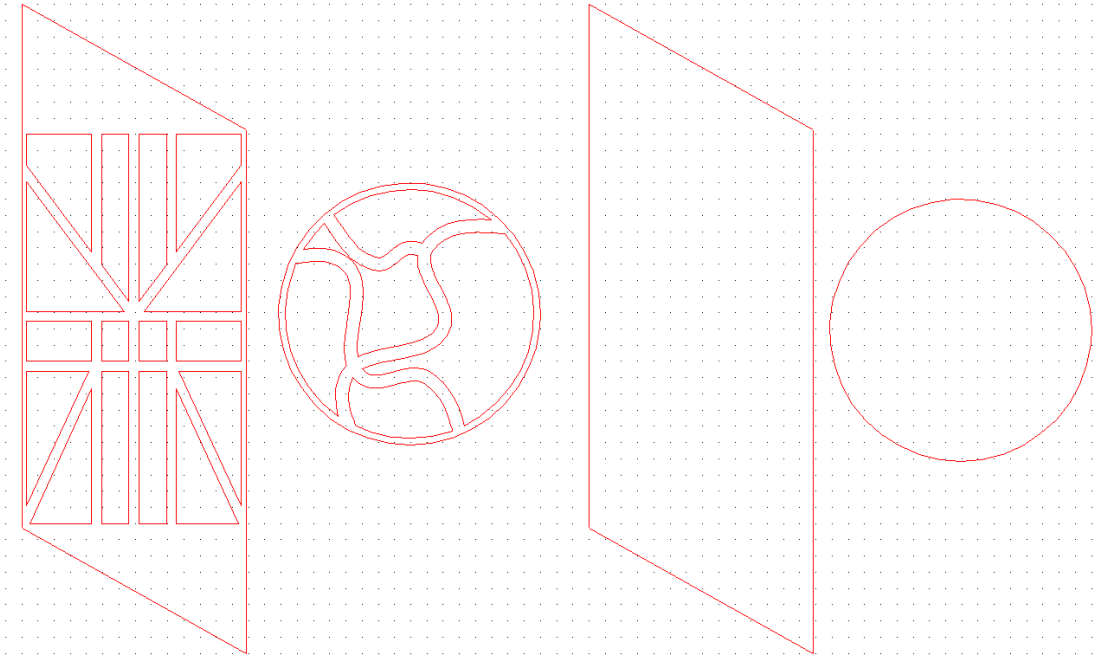

Follow these steps:

- 1. Colour your lines - red to cut, green to engrave.**
- 2. I chose to cut all the lines out I could then put other coloured pieces into the window panes.**

Step 8 - Print Screen to PowerPoint Doc/google drive

Follow these steps:

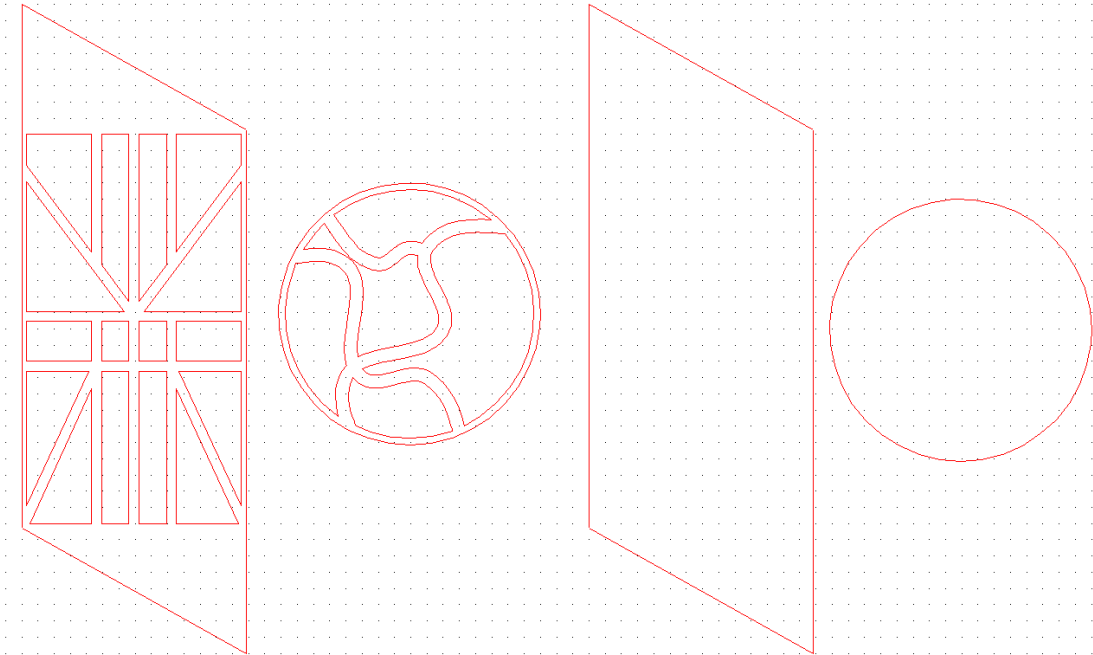

1. **Create a Powerpoint doc. Create three black slides (one for each of your models).**
2. **Print screen your TS/2D model onto a slide and crop and scale to fit.**
3. **When you have created your 3 models you need to upload your PowerPoint doc and your three TS/2D model files to your google drive.**